



# Colfax Half-Marathon

Denver, Colorado

USATF Certificate: CO11051DCR

Effective 11/6/11 - 12/31/2021

Runners go THROUGH fire station bay

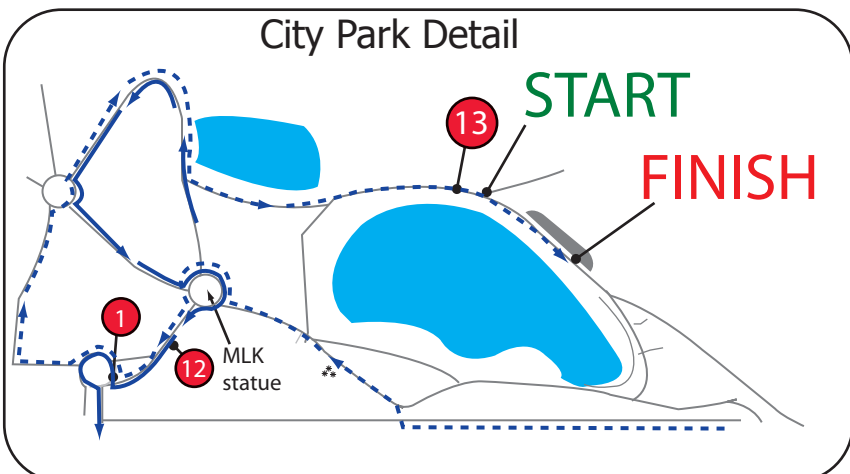
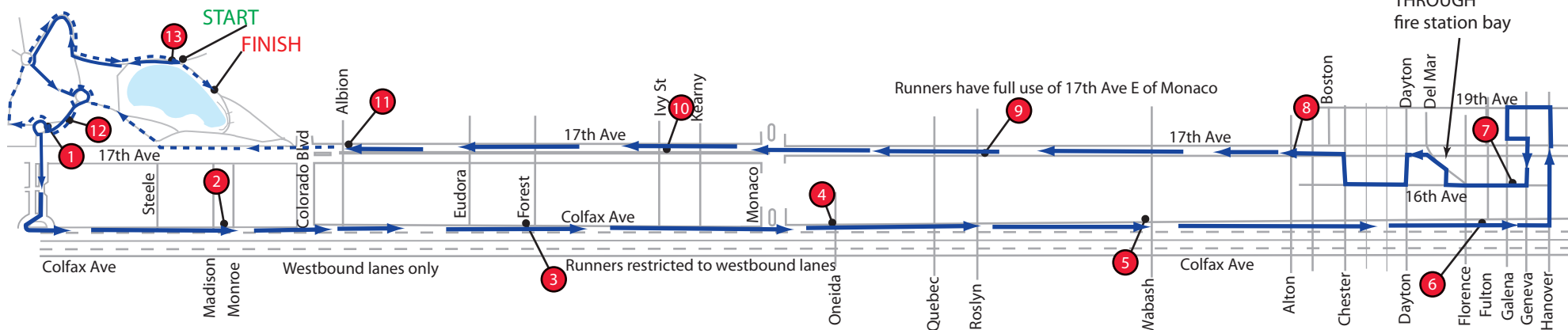

GPS coordinates given ONLY to get close to locations. NOT to be used to replace lost marks. NAD 83

Start	N39.74533	W104.94571
1 Mile	N39.74714	W104.95695
2 Mile	N39.74026	W104.95020
3 Mile	N39.74025	W104.93142
4 Mile	N39.74026	W104.91260
5 Mile	N39.74026	W104.89388
6 Mile	N39.74028	W104.87499
7 Mile	N39.74413	W104.86934
8 Mile	N39.74376	W104.87995
9 Mile	N39.74377	W104.89876
10 Mile	N39.74378	W104.91755
11 Mile	N39.74375	W104.93634
12 Mile	N39.74580	W104.95424
13 Mile	N39.74778	W104.95021
Finish	N39.74737	W104.94828

- Start: Inline with LP 49/39, which is on S side of road, at corner
- Mile 1: 23' N of corner of island, even with walkway to fountain
  - Mile 2: 12' E of alley between Madison and Monroe
  - Mile 3: 31' W of LP 05/26, NW corner of Forest
  - Mile 4: 6' W of traffic light pole on NW corner of Oneida
  - Mile 5: 15' W of LP 04/26, NW corner of Wabash
  - Mile 6: 2' E of pay phone at NW corner of Fulton
  - Mile 7: 4' W of E edge of building at 1600. NE corner of Galena
  - Mile 8: 4' W of E curb of Alton St
  - Mile 9: 15' W of fire hydrant E of Roslyn St
  - Mile 10: 10' E of sidewalk on E side of Ivy St
  - Mile 11: 10' E of E edge of gate at 4101 E 17th. E of Albion
  - Mile 12: 8' S of trail on E side of road
  - Mile 13: 42' E of LP 49/42, which is on S side of road, E of office
  - Finish: 45' N of manhole cover in apron, near S end of apron

RaceMeasure has measured this course following USATF guidelines, and stands by the measurement. (GPS units may give a different course length!)

However, RaceMeasure does not set out the course on race-day, and is not responsible for courses not set out precisely according to this map.

Runners have full use of road in City Park.  
Runners restricted to curb lane of westbound Colfax.  
Runners full use of 17th Ave EAST of Monaco  
Runners use of westbound lanes of 17th, WEST of Monaco



Start elevation: 5265' Finish elevation: 5267' High point: 5416' Low point: 5262'  
Measurement, map, and elevation profile by RaceMeasure, Oct. 2011. www.RaceMeasure.com